

NEW JERSEY BUILDING PERMITS

JANUARY 2026

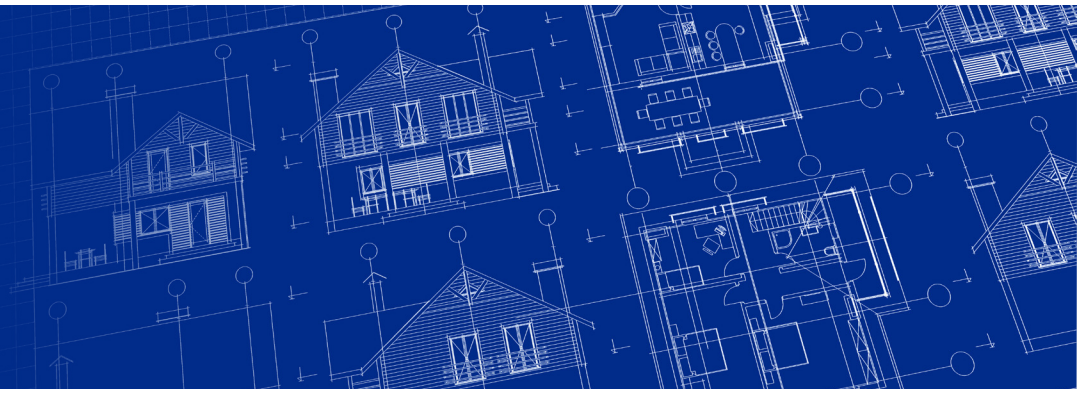

The January 2026 building permits report offers key insights into New Jersey's residential development trends. A total of 3,320 housing units were authorized for construction, which represents less permitting activity compared to the previous month, but more compared to the same period last year.

Insights:

- 85 fewer units than in December 2025
- 318 more units than in January 2025
- 1,184 single-family units authorized
- 1.861 five or more multifamily units authorized

Top Counties by Permits Issued:

- Essex County: 768 units
- Ocean County: 405 units
- Hudson County: 369 units

Top Municipalities by Permits Issued:

- Newark (Essex County): 558 units
- Jersey City (Hudson County): 249 units
- Lakewood Township (Ocean County): 137 units

UNIT CATEGORY

- 1 Unit
- 2 Units
- 3-4 Units
- 5+ Units

TOTAL UNITS JANUARY 2026

- 6 - 20
- 21 - 70
- 71 - 300
- 301 - 700
- 701 - 768

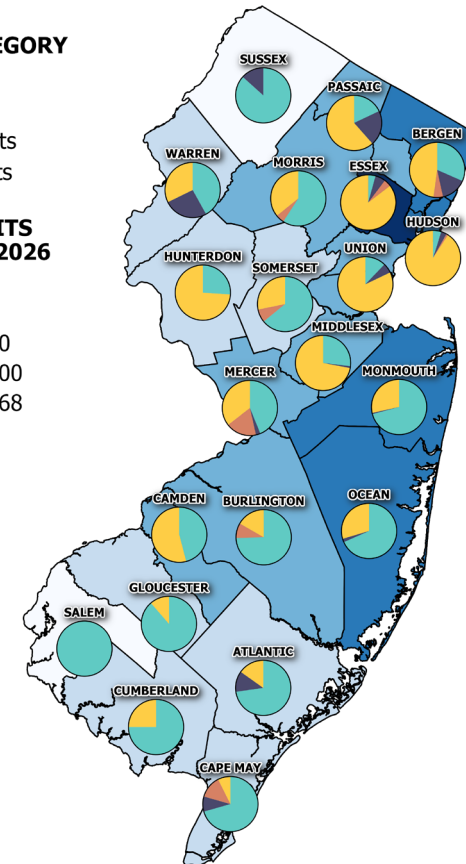

Office of Research
and Information

NEW JERSEY STATE DATA CENTER



NJ.GOV/LABOR/DATA



BUILDING PERMITS, JANUARY 2026



RESIDENTIAL HOUSING UNITS AUTHORIZED BY BUILDING PERMITS, JANUARY 2026

COUNTIES

MUNICIPALITIES

TOTAL UNITS JANUARY 2026

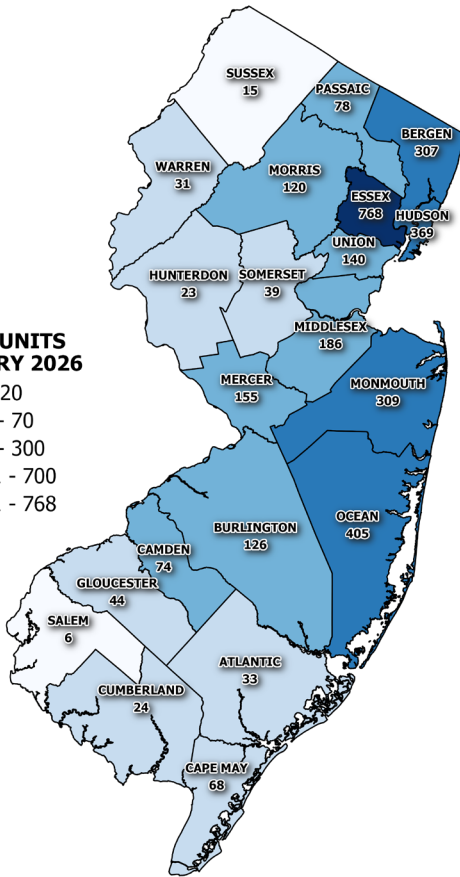
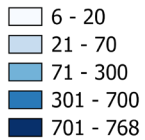

TOTAL UNITS JANUARY 2026

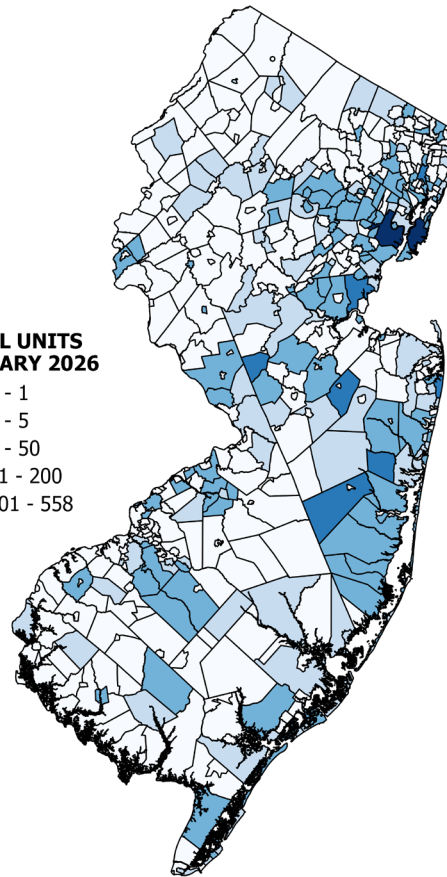
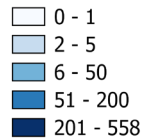

For more information, tables, and maps please visit our Building Permits Survey page [here](#).

SOURCE:

U.S. Census Bureau, Building Permits Survey

DEFINITION OF TERMS:

Residential Dwelling unit (or housing unit):

A house or apartment unit intended for occupancy as separate living quarters and having either a kitchen or cooking facilities; or direct access from the outside through a common hall.

UNIT CATEGORIES:

Single-family house: A house with one dwelling unit includes semi-detached and row houses.

Two-family house: A house with two housing units.

Three- and four-family buildings: Each building contains three or four housing units

Five-or-more-family buildings: Each building contains five-or-more housing units.

NOTE: This report counts individual housing units that are meant to be independently occupied not number of buildings.

The New Jersey State Data Center, along with the NJDOL's Office of Research and Information, prepared this report to provide labor market data, aiming to support public and private sectors in understanding and leveraging these statistics.



STAY INFORMED—subscribe to our publications for exclusive insights and updates at NJ.GOV/LABOR/DATA.